

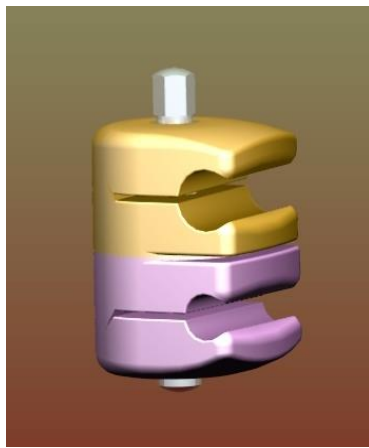

Pin to rod 8x8



Pin to rod 8x6



Pin to rod 8x5



Pin to rod 6x3



Pin to rod 6x4



Pin to rod 6x6

The main points of the new model range of external clamps are fastening compounds/clamps/ of a new type.

Using the basic technical solutions of Hoffman 2 modular connection, the studio team "Dr. Nestorov" through original constructive solutions has created a functionally new product with the following advantages:

- faster installation;
- the clamping of a rod and a pin is realized by means of an axis on which it is made, and a left and a right thread, which clamps simultaneously and twice as fast, with the same force pin and rod;
- groove grooves are provided in the structure against axial deviations of the module elements;
- higher axial compressive strength at the pinion is achieved by increasing the area of the toothed ring;
- Modular compound elements are made by stamping from a specially designed, X-ray, heat-resistant polymer;
- the high-performance, fast printing process allows to achieve extremely competitive, low, basic factory prices;

The clip modules are available in six varieties, covering the possible combinations of 6 and 8 mm bars as well as pins of the basic sizes 3,4,5 and 6 mm.

In fact, the presence of six types of modules, three by 8 and 6 mm, combined with aluminum or fibrocarbon clusters, creates an excellent opportunity to build rigid spatial frames using remote osteosynthesis in emergency traumatology.

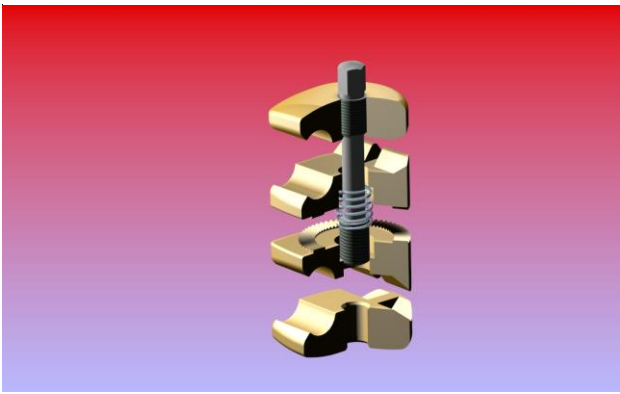

fig.1

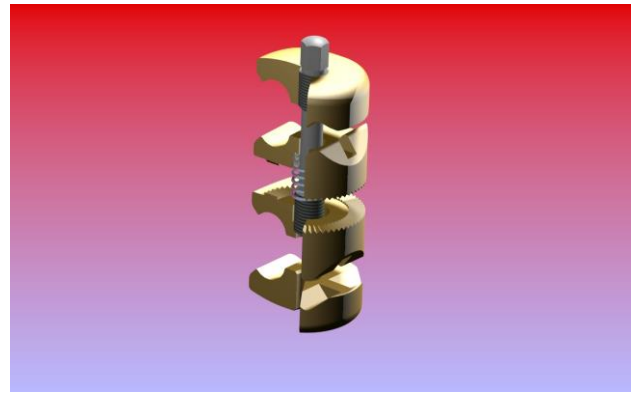

fig.2

Advantages:

- The six types of modules are available as stand-alone products from manufacturers who can supply 6 and 8 mm rods of aluminum, stainless steel, or fiber carbon can form independently sets of regional external fixators.
- Clip modules are X-ray, which allows visual control of the stages of treatment;
- Since the module components are manufactured using the most efficient stamping method for which the corresponding molds are created, the factory price is as competitive as possible. This makes it possible for disposable devices to be disposable.

STERILIZATION up to 125°

RE-USE NOT RECOMMENDED!

Example configurations: Three lower limb sizes - S, M, L



Pelvic Ex Fixator

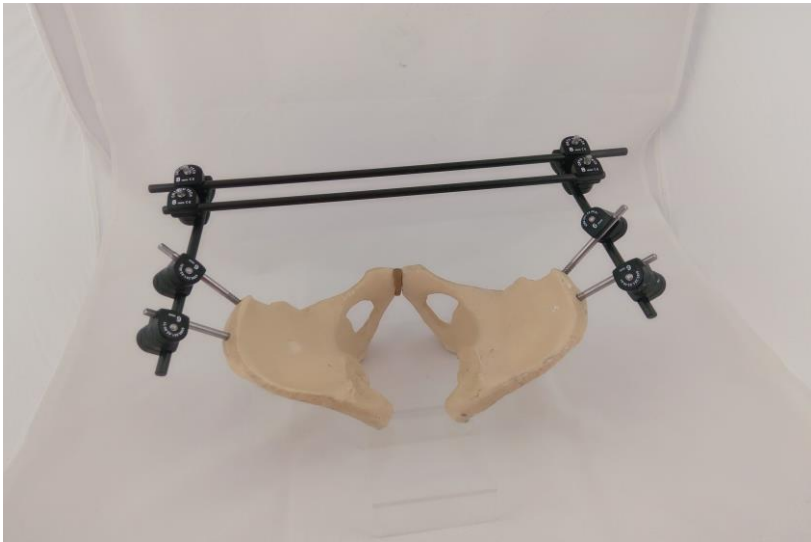
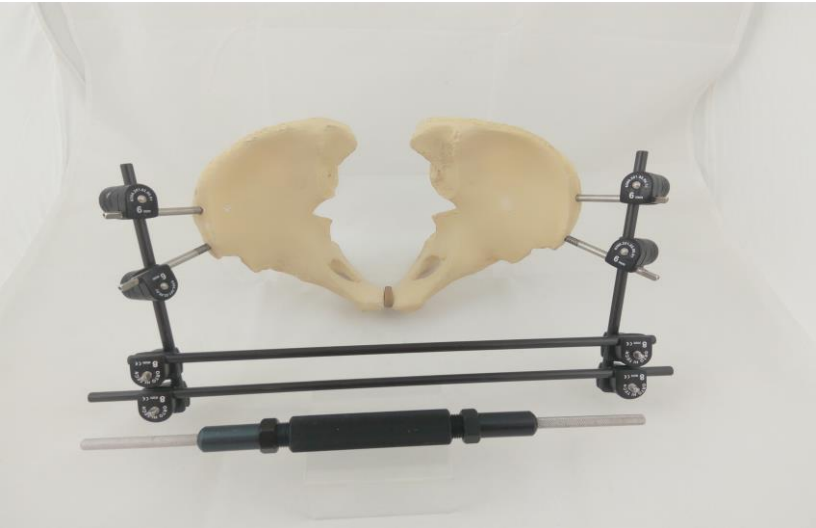

Three upper limb sizes - S, M, L



Ex Fixator Dynamic Ligamentotaxis

